



Design Solutions: Nested Styles in Adobe® InDesign®

Useful for list entries, glossaries, and run-in headings, nested styles let you automatically apply character formatting to designated areas of your paragraphs. With CS4 you can even apply formatting to the first line.

1. Great for lists or glossaries

You may have experienced the pain of manually formatting the first word or two in a list or glossary. With nested styles all of that work is handled in the paragraph style. Here's an example of a nested style. Notice that all of the text through the colon is bold and blue, all of the text after the colon to the end of the paragraph is regular. The nested style was defined so that it applies a character style to all text through the first colon, no matter how many words or characters precede the colon.. The text after the colon is using the formatting that was defined in the Basic Character Formats for the paragraph style.

Kerning: the process of adding or subtracting space between specific pairs of characters.

Tracking: the process of loosening or tightening a block of text.

example of a nested style

2. Start with a character style

To create a nested style you must first create a character style.

- Highlight some text (so you can view the result) and apply character formatting such as bold, italic, a color, or any combination.
- Click on the New Character Style button at the bottom of the Character Styles panel.
- Double-click on Character Style 1 to open the Character Styles Options. Give the new character style a meaningful name. Click OK.
- To remove the character style, click None in the Character Styles panel.

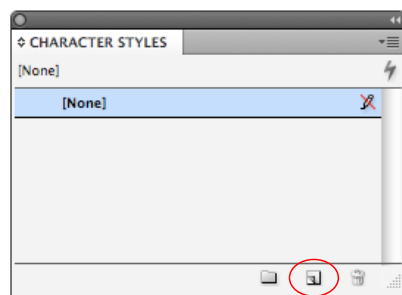

create a new character style

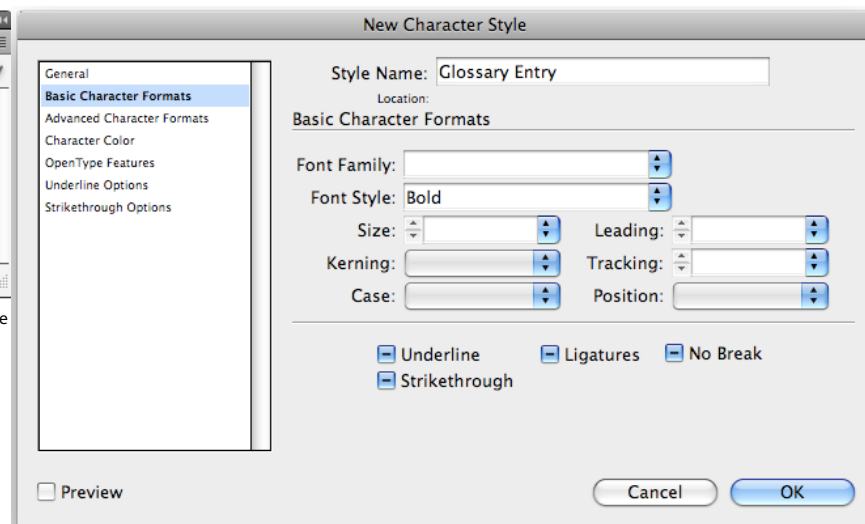

s o k o l
c o n s u l t i n g

© 2008 all rights reserved sokol consulting, inc.



Nested Styles in Adobe® InDesign®

3. Create a nested paragraph style

Now you're ready to create a nested paragraph style. Determine where you want the character style you created to be applied—through the first word?, up to the first colon?, through the first sentence? These are all options.

- Place your insertion point in the paragraph you wish to format.
- Click on the New Paragraph Style button at the bottom of the paragraph styles palette.
- Double-click on Paragraph Style 1 to open the Paragraph Style Options. Give the new paragraph style a meaningful name.
- Click on Drop Caps and Nested Styles at the left of the paragraph style options.
- Click the New Nested Style button to add the first style definition.
- In the Nested Styles area select the character style that you created.
- Select either “through” or “up to”.
- If appropriate, type a number other than one.

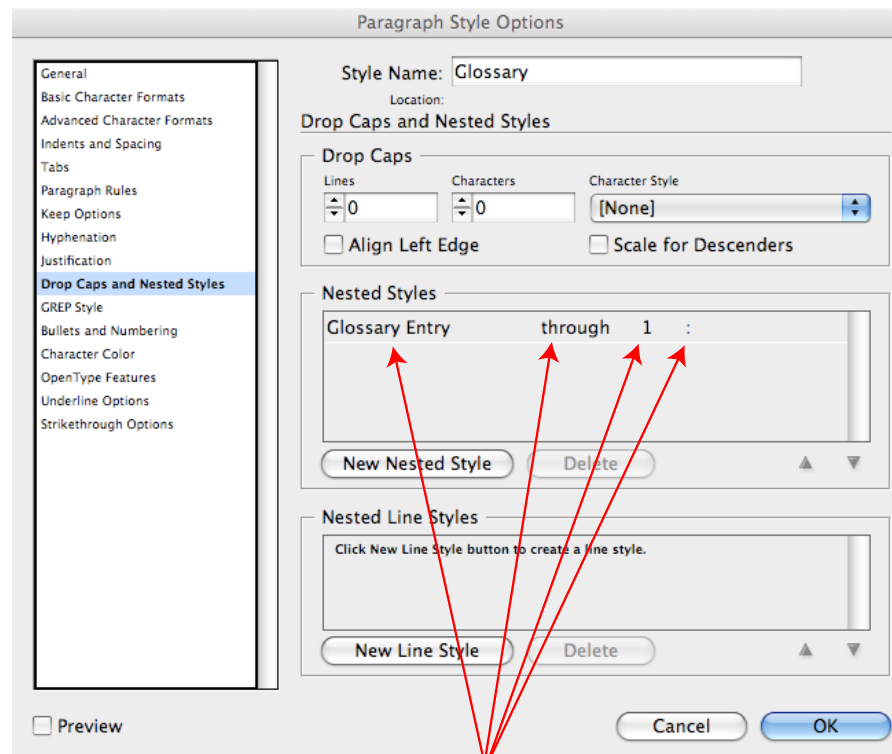

each of these areas is editable

- Click on “Word” to see the list of options. We just typed a colon here to create our style. You can type any character you want in this area.
- You can apply character styles more than once in the paragraph by adding another

- nested style. Use the character style None to display text that uses the default paragraph style.
- Notice that in CS4 you now have the option to apply your character style to the first line of text in your paragraph.



s o k o l
c o n s u l t i n g

© 2008 all rights reserved sokol consulting, inc.



Nested Styles in Adobe® InDesign®

4. Apply your style

Apply your style to your paragraphs and watch them become magically formatted!

Ready for more?

Need to apply character formatting to specific characters in the middle of a paragraph that are not offset by punctuation? In CS4 you can create a GREP style as part of your paragraph style. Now you have the power of using GREP to search for a pattern or expression in your paragraph and automatically apply character formatting. Don't worry, it's easier than it sounds. Look for this topic in another Design Solutions.

