



Design Solutions: Smart Filters in Adobe® Photoshop®

You've been using Photoshop's filters for years, but have you taken advantage of the non-destructive workflow provided by the new smart filters feature? Here are some tips to get you started:

1. Make a Selection

Much of the time you want to apply a filter to only a portion of your image. Begin by making a selection—and don't work too hard. Select either the object or the background, whichever is easier. You can always invert the selection later. If you're applying your filter to an entire layer, you can skip this step. To reverse the selection, choose **Select > Inverse**. You can do this again later using the Masks panel.

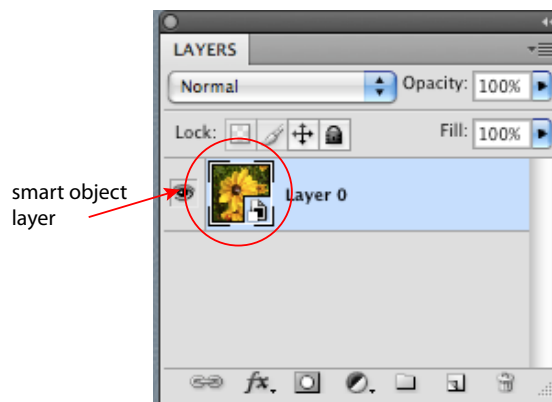

2. Choose Filter > Convert for Smart Filters

You'll see a message indicating that the current layer will be converted to a Smart Object. That's all good, click OK.

3. Choose Filter > Filter Gallery

You could also just choose the filter you want from the list, but the Filter Gallery is a great way to experiment with the filters to get exactly what you want. Remember that in the Filter Gallery you can click to add additional filters and rearrange them to change the resulting effect. When you have the look you want, click OK.

4. Observe the Layers Panel

This is where you begin to see the benefits. Observe the layer mask and the sub-layer that either says "Filter Gallery" (if that's what you used) or the name of the filter you selected.

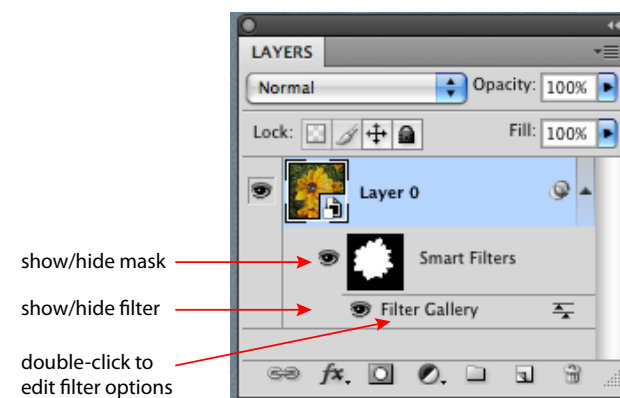



Smart Filters in Adobe® Photoshop®

5. Show and Hide the Filter

Click the eyeball icon next to the filter name to show or hide the filter. Great for experimenting! Click the eyeball icon next to the mask to show or hide the mask.

6. Edit the filter options

Double-click the filter name to open the Filter Gallery or the options for the single filter you applied. Come back to change the settings as many times as you'd like—all the information is in the sub-layer and is being applied non-destructively to your image.

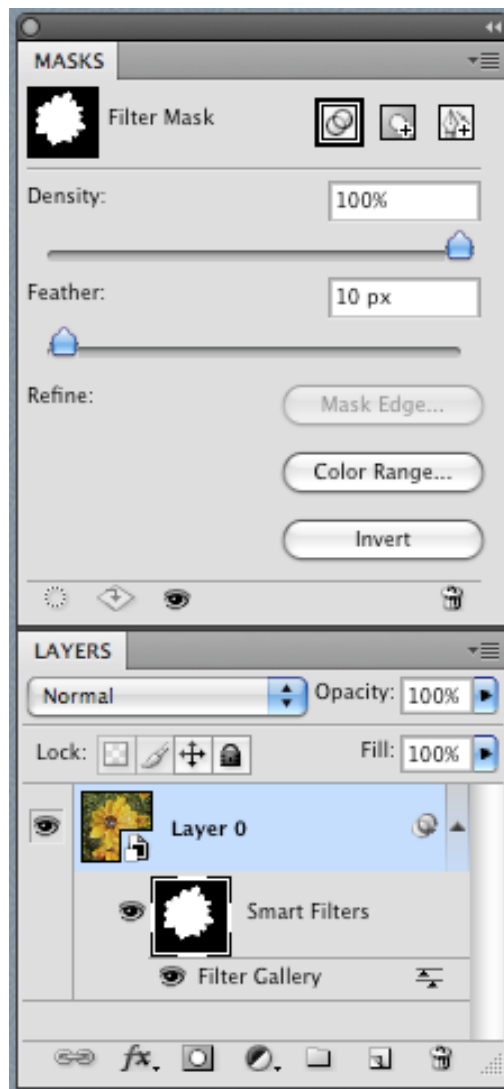

7. Edit the layer mask

My personal favorite. Perhaps you have noticed an area of your image that should or should not have the filter applied. Paint in the layer mask to edit. Use the new Masks panel to adjust Density (the opacity of the mask) or to set a Feather border. If you forgot to reverse the selection earlier, click the Invert button in the Masks panel.



sokol
consulting

© 2008 all rights reserved sokol consulting, inc.



Respectfully submitted,
Patti D. Sokol, Instructor
www.sokolconsulting.com

CERTIFIED INSTRUCTOR